

FEATURES

- Wide Bandwidth
- Low Insertion Loss
- Lower limiting threshold
- Miniature Sizes for drop-In Assembly
- Rugged/compact Thin Film Construction
- High power handling



APPLICATIONS

- Front End Protection for LNA's
- Power Leveling (Limiting)
- Receiver Protection

SPECIFICATIONS@25°C:

Part Number	Frequency Range (GHz)	Insertion Loss (dB)	Threshold (dBm)	Spike Leakage (dBm)	VSWR (Max)	Input Power (Watt.Avg)	Peak Power (W.Max)	Recovery Time (ns)	Pulse Width (us)	Duty Cycle %	Case Type
MLT001030T25	0.01-3	0.6	25	/	1.7:1	10	/	/	/	/	LT21(N)
MLT002002T27	0.02-0.26	1	/	/	16dB	27dB	/	10	/	/	LT11
MLT001180T10	0.1-18	2.5	10	13	2:1	2	200	50	1	1	LT1
MLT003050T20	0.38-5	2	/	20	1.8:1	100(AVE)	/	1us	/	/	LT21
MLT005010T17	0.5-1	0.5	17	19	1.4:1	2	200	50	1	1	LT1
MLT005010T10	0.5-1	0.6	10	12	1.4:1	2	200	50	1	1	LT1
MLT005010T15	0.5-1	0.8	15	17	1.5:1	10	1000	50	1	1	LT1
MLT005020T18	0.5-2	0.4	18	/	1.4:1	2	100	/	1	/	LT9
MLT005030T15	0.5-3	1.3	15	/	1.5:1	60	1KW	/	/	/	LT21
MLT005030C15	0.5-3	1.3	15	/	1.5:1	60	1KW	/	/	/	LT12
MLT005042T18	0.5-4.2	1.2	18	/	1.8:1	13	1.3KW	/	8ms	1	LT15
MLT005042T20	0.5-4.2	1.2	20	/	1.8:1	10	1KW	/	8ms	1	LT17
MLT005180T10	0.5-18	2.5	10	13	2.2:1	2	200	50	1	1	LT1
MLT005200T10	0.5-20	2.5	10	13	2.2:1	2	200	50	1	1	LT1
MLT010020T17	1-2	0.5	17	19	1.4:1	2	200	50	1	1	LT1
MLT010020T10	1-2	0.7	10	12	1.5:1	2	200	50	1	1	LT1
MLT010020T15	1-2	1	15	17	1.5:1	10	1000	50	1	1	LT1
MLT010030T13	1-3	1	13	/	1.4:1	12	100	30us	/	12	LT11
MLT010180T13	1-18	2.6	13	/	2.2:1	12	100	/	/	12	LT11
MLT010400T18	1-40	3.5	18	/	2.4:1	1	/	/	1	1	LT10
MLT011017T16	1.1-1.7	0.7	16	12	1.5:1	2	100	50	1	1	LT1
MLT012014T19H600	1.2-1.4	0.5	/	1W	1.3:1	72	600	2us	300	10	LT5
MLT012014T17	1.2-1.4	0.6	/	/	1.5:1	/	19dBm	/	110us	5	LT21
MLT020040T17	2-4	0.7	17	19	1.5:1	2	200	50	1	1	LT1
MLT020040T10	2-4	0.9	10	12	1.5:1	2	200	50	1	1	LT1



WIDE BAND PIN DIODE LIMITER

Part Number	Frequency Range (GHz)	Insertion Loss (dB)	Threshold (dBm)	Spike Leakage (dBm)	VSWR (Max)	Input Power (Watt.Avg)	Peak Power (W.Max)	Recovery Time (ns)	Pulse Width (us)	Duty Cycle %	Case Type
MLT020040T15	2-4	1.2	15	17	1.5:1	7	700	50	1	1	LT2
MLT020180T17	2-18	2	17	19	2.1:1	2	200	50	1	1	LT1
MLT020180T10	2-18	2.5	10	12	2.2:1	2	200	50	1	1	LT1
MLT020180T15	2-18	2.5	15	17	2.5:1	5	500	50	1	1	LT1
MLT020180T18	2-18	1.8	18	/	1.9:1	1	100	/	/	/	LT18
MLT020180T30	2-18	2	30	35	.8:1	1	400	100	1	/	LT1
MLT026031T14	2.6-3.1	0.7	14	18	2:1	2	100	100	/	/	LT16
MLT027030T13	2.7-3	1	13	/	1.5:1	30	100	250	125	30	LT12
MLT027030T15	2.7-3	0.5	/	/	1.3:1	20	/	/	1	20	LT2
MLT030035T13	3-3.5	0.6	13	/	1.5:1	/	40	/	300	20	LT11
MLT031035T18	3.1-3.5	1	18	/	1.6:1	/	/	/	300/200	10/20	LT12
MLT040080T17	4-8	1.1	17	19	1.5:1	2	200	50	1	1	LT1
MLT040080T10	4-8	1.3	10	12	1.5:1	2	200	50	1	1	LT1
MLT040080T15	4-8	1.6	15	17	1.6:1	5	500	50	1	1	LT1
MLT044050T17	4.4-5	1.6	17	20	1.6:1	20	/	50	/	/	LT1
MLT044051T13	4.4-5.1	1	13	/	1.6:1	50	/	50us	25ms	50	LT12
MLT050080T18	5-8	1.1	18	/	1.5:1	20	1000	/	1	/	LT4
MLT080050T18	5-8	1.7	18	/	1.6:1	30	/	/	/	/	LT21
MLT069083T18	6.9-8.3	1	18	/	1.6:1	/	/	1US	150	10	LT13
MLT080120T13	8-12	1.8	13	/	1.6:1	2	/	1s	1	/	LT11
MLT080120T15	8-12	1	15	/	1.8:1	1	/	/	/	/	LT6
MLT080120T10	8-12	1.8	10	12	1.5:1	2	100	50	1	1	LT1
MLT080180T17	8-18	1.9	17	19	1.9:1	2	200	50	1	1	LT1
MLT080180T15	8-18	2.2	15	17	2:1	5	500	50	1	1	LT1
MLT080180T20	8-18	2.3	20	/	2.1:1	3	1000	1000	/	/	LT1
MLT085095T13	8.5-9.5	1.6	13	/	1.7:1	20CW	/	/	/	/	LT21
MLT090096T16	9-9.6	1.5	16	20	1.6:1	13(AVE)	/	/	1-2	0.1	LT19
MLT093095T13	9.3-9.5	1.5	13	/	1.6:1	/	400	/	200	20	LT20
MLT093095T20D	9.3-9.5	1.5	20	30	1.4:1	2	55dBm	1us	1	/	LT1
MLT096100C	9.6-10	1	/	10	15dB	/	46dBm(Typ)	0.5us	200	20	LT1
MLT096100H10	9.6-10	1	/	10	15dB	/	46/49dBm	0.5us	200	20	LT1
MLT116137T18	11.6-13.7	2	18	/	1.8:1	40	/	/	/	/	LT14
MLT120180T13	12-18	2.5	13	/	2.2:1	2	/	1s	1	/	LT11
MLT130150T13	13-15	2.3	13	/	1.8	15	300	/	9	4-5	LT11



WIDE BAND PIN DIODE LIMITER

Part Number	Frequency Range (GHz)	Insertion Loss (dB)	Threshold (dBm)	Spike Leakage (dBm)	VSWR (Max)	Input Power (Watt.Avg)	Peak Power (W.Max)	Recovery Time (ns)	Pulse Width (us)	Duty Cycle %	Case Type
MLT130150T16	13-15	3	16	/	2.1:1	1KW Min	/	/	9	5-6	LT19
MLT167172T18	16.75-17.25	2.2	18	/	1.8:1	40dBm	/	/	/	/	ML11
MLT180260T18	18-26	2.5	18	/	2	1	/	/	1	1	LT10
MLT180400T13	18-40	4.5(Typ.)	13	/	3:1	/	/	/	/	/	LT18
MLT180400T18	18-40	2.8	18	/	2.2:1	1	10	/	1	1‰	LT10
MLT180400H18	18-40	3.2	18	/	2.2:1	1	10	/	1	1	LT22
MLT260400T18	26-40	3	18	/	2.2:1	1	/	/	1	1	LT10
MLT341349T18	34.1-34.9	3.5	18	/	2:1	36dBm	/	/	/	/	LT23
MLT350360T15	35-36	2.8	15	/	2.2:1	1	/	200	/	/	LT10

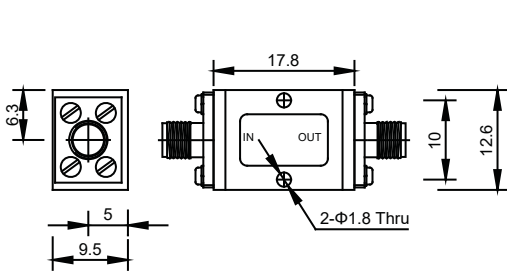

LT1

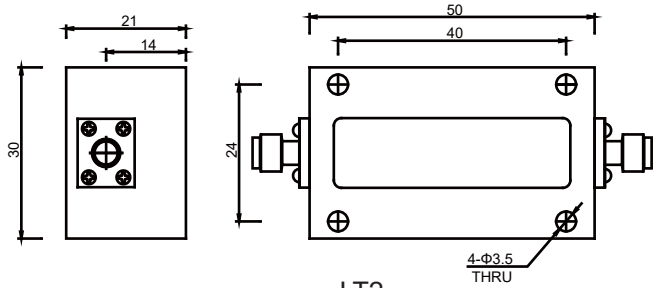

LT2

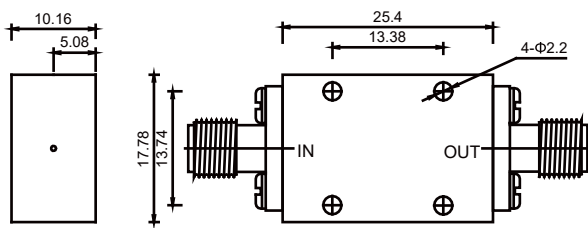

LT4

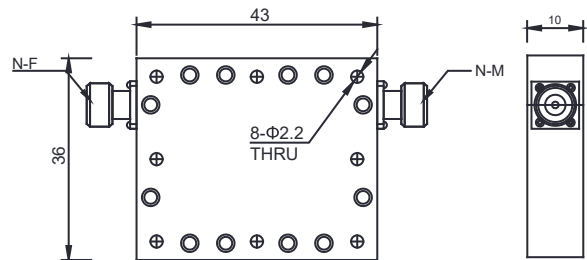

LT5

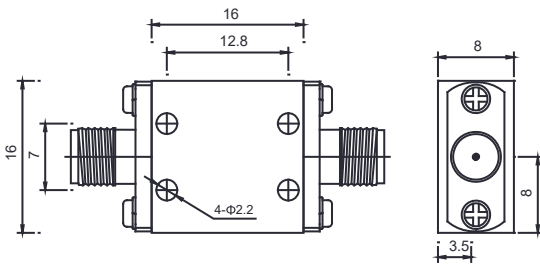

LT6

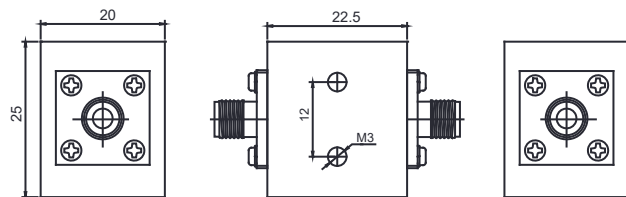

LT7

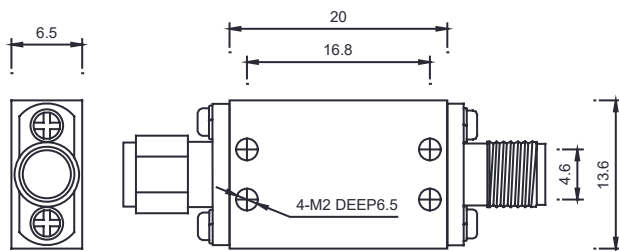

LT8

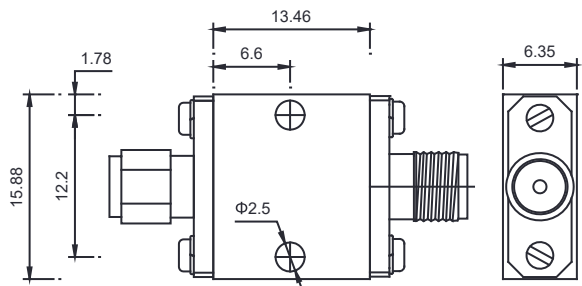

LT9

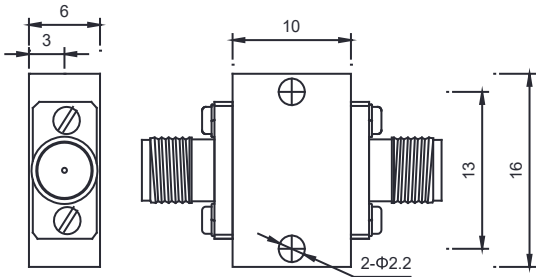

LT10

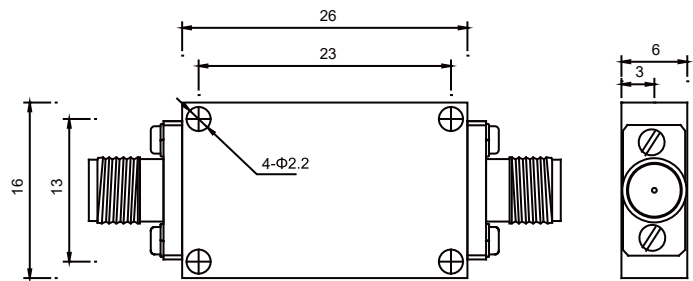

LT11

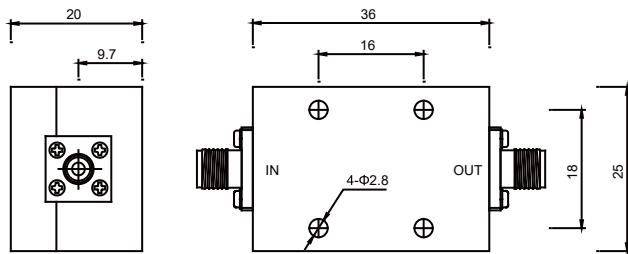

LT12

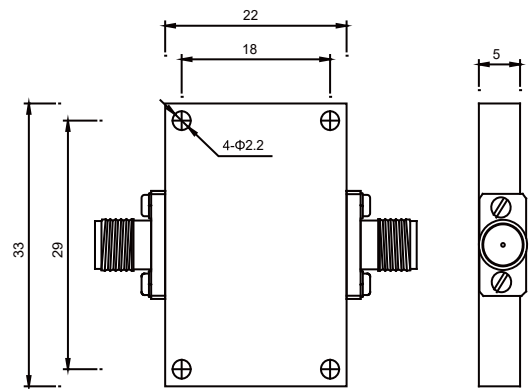

LT13

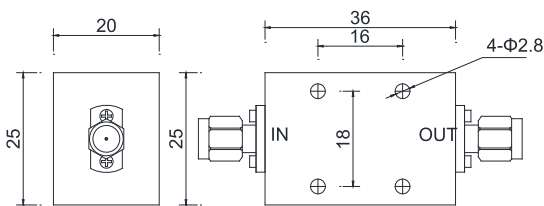

LT15

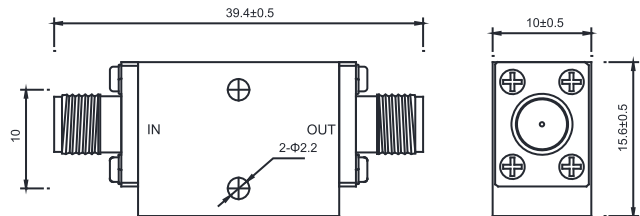

LT17

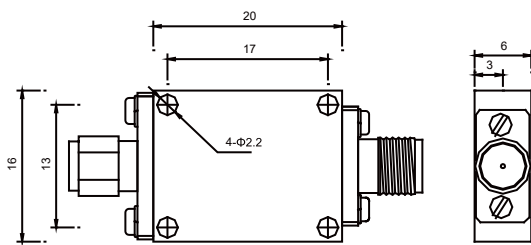

LT16

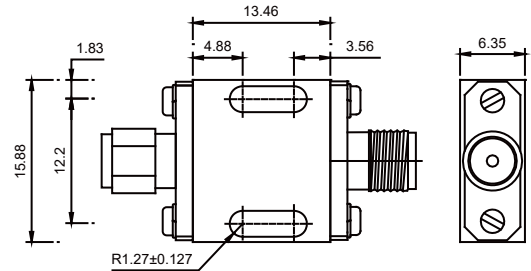

LT18

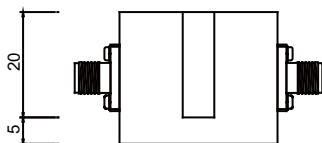

T19

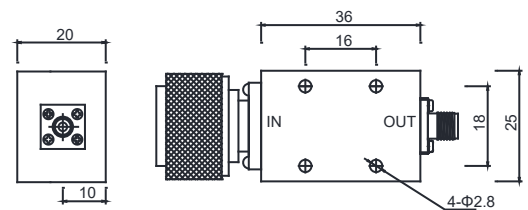
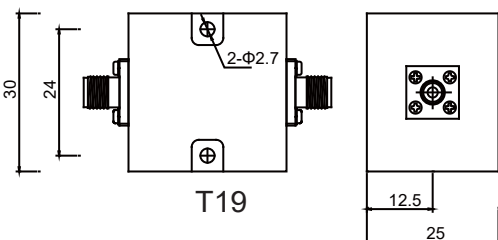

LT20

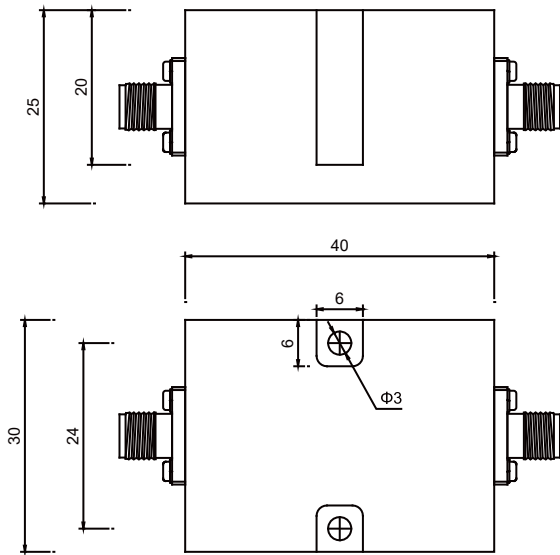

LT21

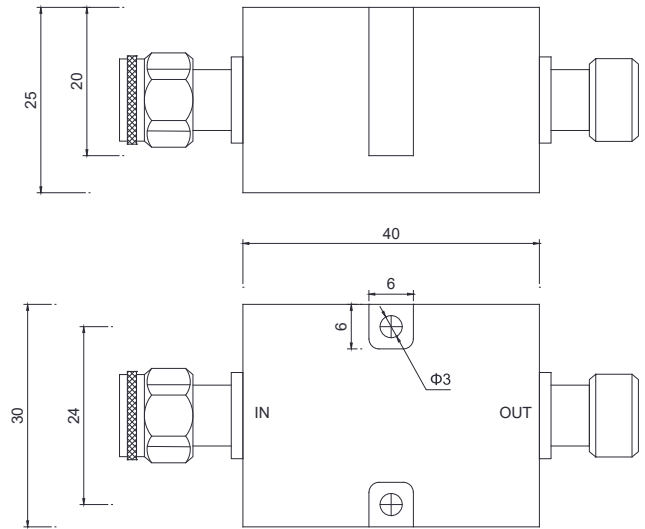

LT21(N)

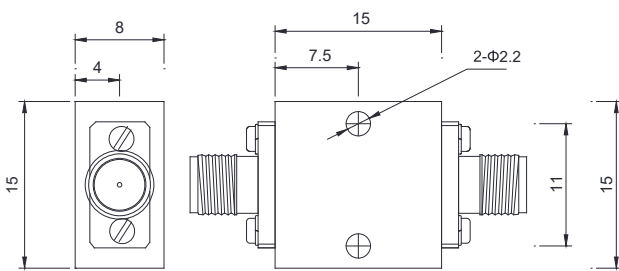

LT22

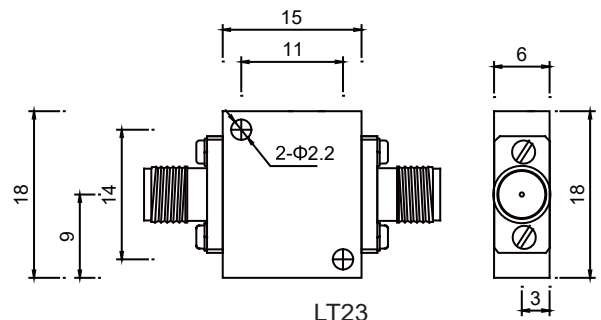

LT23